

MS-700™

ELECTROSTATIC SPRAYER

OPERATOR'S MANUAL



■ For Indoor and Outdoor Commercial Use

▼ **Operator's Manual**
ENGLISH | 2-11

For service and support, contact
www.ServiceTechTeam.com.

BYOPLANET®
Advanced Chemical Delivery Systems

ByoPlanet.com

SAFETY NOTICES	
Warnings	3
Safety Decal	4
Protective Gear	5
IMPORTANT SAFETY PRECAUTIONS	
Power Connection	5
Grounding Instructions	5
Extension Cord	5
Shock/Electrical Hazard	6
General Safety	6
Chemicals	6
SYSTEM COMPONENTS	
MS-700 Electrostatic Sprayer Base Unit	7
MS-700 Electrostatic Sprayer	7
OPERATING INSTRUCTIONS	
Preparing the Spray Area	8
Unit Operation/Setup	8
Sprayer Operation During Cleaning	8
Changing ByoPlanet-Approved Products	8
After Use and Storage	8
MAINTENANCE	
Exterior Frame	9
Peristaltic Pump	9
SPECIFICATIONS	10
TROUBLESHOOTING	10
EQUIPMENT WARRANTY	11

SAFETY NOTICES

This manual contains information that is important for you to know and understand before operating the ByoPlanet® MS-700™ Electrostatic Sprayer. This information relates to protecting your safety and ensures product reliability and performance. It is the owner's responsibility to ensure that all who operate this equipment read this manual.

Warnings

To help you recognize this information we use the warning symbols below. Please read the manual carefully, and pay special attention to the symbols and warning labels. Warning labels indicate a potentially hazardous situation which, if not avoided, could result in death or serious injury.

WARNINGS

- Read and fully understand the ByoPlanet® MS-700™ Electrostatic Sprayer Operator's Manual prior to using the electrostatic sprayer.
- Read and fully understand ByoPlanet-approved product labels prior to using any liquid product with the ByoPlanet® MS-700™ Electrostatic Sprayer.
- ByoPlanet® MS-700™ Electrostatic Sprayers are for both indoor and outdoor commercial use. Bystanders and pets should not be in the area during application.
- ByoPlanet® MS-700™ Electrostatic Sprayers should not be operated below 55°F (12.5°C).
- ByoPlanet® MS-700™ Electrostatic Sprayers should never be used in any area containing volatile chemicals, nor should they be used in hazardous environments or any area containing volatile or explosive levels of gas, vapor or airborne particles.
- ByoPlanet® MS-700™ Electrostatic Sprayers should never be used by untrained personnel.

WARNINGS

PRESSURIZED EQUIPMENT HAZARD

Fluid from equipment that leaks or ruptures from a component can splash in the eyes or on skin, causing serious injury. In order to help prevent a leak or rupture:



- Check hoses, tubes and couplings daily. Replace worn or damaged parts immediately.

WARNINGS

PLASTIC PARTS CLEANING SOLVENT HAZARD

Many solvents can degrade plastic parts and cause them to fail, which can lead to serious injury or property damage. In order to help prevent against degradation:



- Use only compatible water-based solvents to clean plastic structural pressure containing parts.
- See technical data in this and all other equipment instruction manuals. Read fluid and solvent manufacturer's Safety Data Sheets (SDS) and recommendations prior to use.

WARNINGS

FIRE, EXPLOSION AND ELECTRIC SHOCK HAZARD

Flammable fumes, such as solvent and paint fumes, in work areas can ignite or explode. To help prevent fire, explosion and electric shock:



- Electrostatic equipment must be used only by trained, qualified personnel who understand the requirements of this manual.
- Stop operation immediately if static sparking occurs or you feel shock. Do not use equipment until you identify and correct the problem.
- Use and clean equipment only in well-ventilated area.
- Never spray a flammable chemical (with a flash point less than 140°F [60°C]).
- Do not plug or unplug power cords or turn lights on or off when flammable fumes are present.
- Keep spray area free of debris, including solvents, rags, gasoline or any flammable chemicals.
- Keep a working fire extinguisher in the work area.

WARNINGS

PERSONAL PROTECTIVE EQUIPMENT

Wear appropriate protective equipment when in the work area to help prevent serious injury.

- Refer to product specific ByoPlanet® Safety Data Sheets (SDS) for any additional Personal Protective Equipment (PPE).

WARNINGS

EQUIPMENT MISUSE HAZARD

Misuse can cause death or serious injury



- Do not operate the unit when fatigued or under the influence of drugs or alcohol.
- Use fluids and solvents that are compatible with equipment wetted parts. See technical data in all equipment manuals. Read fluid and solvent manufacturer's warnings. For complete information about your material, request SDS from distributor or retailer.
- Do not leave the work area while equipment is energized.
- Turn off all equipment when not in use.
- Check equipment daily. Repair or replace worn or damaged parts immediately with genuine replacement parts from trusted ByoPlanet® partners only.
- Do not alter or modify equipment. Alterations or modifications void your ByoPlanet® MS-700™ warranty and agency approvals, and create safety hazards.
- Route hoses and power cords away from traffic areas, sharp edges, moving parts and hot surfaces.

WARNINGS

CHEMICAL USE HAZARD

Each chemical, such as a disinfectant, has a unique set of hazards and needs to be handled properly to ensure worker safety.

- The ByoPlanet® MS-700™ Electrostatic Sprayer can only be used with products that have been approved by ByoPlanet®. Never spray any liquid product that is not a ByoPlanet®-approved product. The ByoPlanet® MS-700™ Electrostatic Sprayer warranty is voided if the ByoPlanet® MS-700™ Electrostatic Sprayer is used with products that are not approved by ByoPlanet®. Be aware that many chemical liquids can be harmful if they are not used properly.
- Read and understand the ByoPlanet®-approved product's SDS and label prior to use.
- Be aware of first-aid procedures related to the product in use.
- It is a violation of Federal law to use a chemical in a manner inconsistent with its label.
- Use personal protective equipment as detailed by the ByoPlanet®-approved product's SDS.
- For use with non-flammable, non-combustible and non-volatile fluids only. Never spray a flammable chemical (flash point less than 140°F [60°C]).
- Ensure the area being sprayed has proper ventilation.
- Store all chemicals in original containers in a cool, dry place, away from heat and open flames.
- Do not reuse or refill a chemical container.
- To dispose of ByoPlanet®-approved products refer to product labels.

Safety Decal

This decal is located on the top-most deck surface forward of the bottle storage location.

⚠ WARNING!

- Always wear appropriate Personal Protective Equipment (PPE), as detailed in the User Manual, when using this device. Refer to product specific ByoPlanet® Safety Data Sheets (SDS) for any additional PPE.
- Follow instructions and precautions listed on ByoPlanet® manufacturing product labels.
- Only use ByoPlanet®-approved products through the ByoPlanet® MS-700™ Electrostatic Sprayer.
- Inspect power cord, sprayer and external tubing for damage prior to use. DO NOT use if damage is present.
- Always use with a grounded electrical plug and outlet.
- Use device only as intended. Direct spray only toward appropriate surfaces.

⚠ ¡ADVERTENCIA!

- Cuando use este dispositivo, siempre use el equipo de protección personal (EPP) apropiado, como se detalla en el Manual del Usuario. Consulte las Fichas de Datos de Seguridad (SDS) para cualquier EPP adicional.
- Siga las instrucciones y precauciones que se listan en las etiquetas de fabricación del producto ByoPlanet®.
- Utilice solamente productos ByoPlanet® aprobados por el Atomizador Electrostático MS-700™.
- Antes de usarlo inspeccione el cable de electricidad, el atomizador y la tubería externa por daños. NO lo use si hay daños presentes.
- Siempre usarlo con un enchufe y toma de corriente eléctrica con conexión a tierra.
- Solamente utilice el dispositivo para lo que fue diseñado. Solo rocíe directamente en las superficies adecuadas.

⚠ AVERTISSEMENTS!

- Au moment d'utiliser le pulvérisateur, toujours porter un équipement de protection personnelle (EPP) adéquat, tel que décrit dans le manuel de l'utilisateur. Se reporter à la fiche signalétique du produit nettoyant ByoPlanet® afin de connaître tout autre EPP requis pour son emploi.
- Suivre les instructions et les mises en garde indiquées sur l'étiquette d'origine de chaque produit ByoPlanet®.
- Utiliser le pulvérisateur électrostatique MS-700™ uniquement avec les produits ByoPlanet® approuvés à cette fin.
- Avant l'emploi, inspecter le cordon d'alimentation, l'appareil lui-même et les tubes externes pour vérifier l'absence de dommages. NE PAS utiliser le pulvérisateur en présence de dommages.
- Toujours brancher le pulvérisateur dans une prise de courant avec mise à la terre.
- Utiliser le pulvérisateur strictement selon le mode d'emploi. Toujours diriger le jet directement vers les surfaces à traiter.

Protective Gear

Personal Protective Equipment (PPE) must comply with the American National Standards Institute's ANSI Z87.1-1989 standard if purchased after July 5, 1994, or ANSI Z87.1-1968 or with the standard of the country in use.

- Eye and face PPE shall be distinctly marked to facilitate identification of the manufacturer. (1910.133[a][4]).
- The following minimum requirements must be met by all protective devices. Protectors shall:
 - Provide adequate protection against the particular hazards for which they are designed
 - Be of safe design and construction for the work to be performed
 - Be reasonably comfortable when worn under the designated conditions
 - Fit snugly and not unduly interfere with the movements of the wearer
 - Be durable
 - Be capable of being disinfected
 - Be easily cleanable
 - Be distinctly marked to facilitate identification only of the manufacturer

THE USE OF EYE WEAR PROTECTION IS RECOMMENDED AS MINIMUM PPE WHEN USING THIS DEVICE.

ALWAYS USE APPROPRIATE PPE, LISTED ON THE BYOPLANET®-APPROVED PRODUCT'S SAFETY DATA SHEET (SDS).

ByoPlanet® SDSs CAN BE FOUND AT:
WWW.SERVICETECHTEAM.COM

IMPORTANT SAFETY PRECAUTIONS

When using an electrical appliance, it is important to understand that some circuits are electrically live, even when the power switch is in the off position. Basic safety precautions should always be followed to reduce the risk of burns, fire, electrical shock, injury and/or death.

Power Connection

Our power plug must be used with a three-pronged, grounded outlet, rated for no less than 15A service. Always verify before product use. This appliance is for use on a nominal 120V/60Hz circuit with a verified ground plug. Check with a qualified electrician to ensure you have the correct electrical service and grounding.

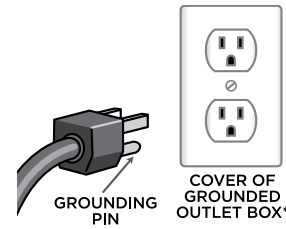

*120-volt grounded connectors shown. 220/240-volt grounded connectors will differ in shape.

Grounding Instructions

This appliance must be grounded. In the event of malfunction or breakdown, grounding provides a path of least resistance for an electric current to reduce the risk of electric shock. This appliance is equipped with a cord having an equipment-grounding conductor and a grounding plug. The plug must be plugged into an appropriate outlet that is properly installed and grounded in accordance with all local codes and ordinances. Never use an adapter that removes the ground connection with this device.

DANGER: Improper connection of the equipment-grounding conductor can result in a risk of electric shock. The conductor with insulation having an outer surface that is green, with or without yellow stripes, is the equipment-grounding conductor. If repair or replacement of the cord or plug is necessary, do not connect the equipment-grounding conductor to a live terminal. Check with a qualified electrician or serviceman if the grounding instructions are not completely understood or if in doubt as to whether the appliance is properly grounded. Do not modify the plug provided with the appliance — if it will not fit the outlet, have a proper outlet installed by a qualified electrician. Never use an adapter that removed the ground connection with this device.

Extension Cord

ByoPlanet® provides a 25-foot (7.6m) extension cord with each ByoPlanet® MS-700™ Electrostatic Sprayer and strongly recommends that you use this approved extension cord. Make sure your extension cord is in good condition. Inspect cords periodically and replace if damaged. If an alternate extension cord is used, be aware that an undersized extension cord will cause a drop of in-line voltage, which could result in a loss of power, damage to the product and/or overheating. Always use a sufficiently rated extension cord.

IMPORTANT: ByoPlanet® recommends using a 12/3 gauge extension cord, no longer than 100 feet (30.5m). For outside or wet environment application, use a GFCI (ground fault circuit interrupter) in-line adapter or outlet to help avoid risk of electrical shock. The GFCI should be placed as close to the outlet as possible.

Shock/Electrical Hazard

As with most electrical appliances, electrical parts are electrically live even when the switch is off. To reduce the risk of burns, fire, electric shock or injury:

1. Use this unit only for its intended use, as described in this manual.
2. Do not use while bathing.
3. Do not place or store unit where it can fall or be pulled into water or other liquid.
4. If unit falls into water, unplug immediately. Do not reach into water to retrieve.
5. Never operate this unit if it has been dropped, damaged or is working improperly. Contact Service Tech Team at www.servicetechteam.com.
6. Keep the cord away from heated surfaces.
7. Never block the air openings of the unit or place it on a soft surface (bed or couch), where the air openings may become blocked.
8. Never drop or insert any object into any opening.
9. Do not use with a damaged or broken power cord.
10. Do not attempt to operate if the unit if the device temperature is below 55°F (12.5°C). If stored below 55°F (12.5°C), move the unit to a warm environment and allow the unit to acclimate before operation.
11. Never store at a temperature below 32°F (0°C) or above 140°F (60°C).
12. This unit may be warm when in use. Do not let heated surface touch bare skin.

CAUTION: Electrostatic nozzle. Do not touch or insert any foreign object into the nozzle.

General Safety

Lack of attention to safety can result in reduced efficiency, accidents, personal injury or death. Watch for safety hazards and correct deficiencies promptly. Use the following safety precautions as a guide when using this machine.

1. Read the operator's manual. Failure to do so is considered misuse of the equipment.
2. Use the ByoPlanet® MS-700™ Electrostatic Sprayer unit only for its intended use, as described in this manual.
3. Before operating equipment, become familiar with all caution and warning decals affixed to the equipment.
4. Do not use the ByoPlanet® MS-700™ Electrostatic Sprayer in a hazardous location.
5. Only trained personnel familiar with the ByoPlanet® MS-700™ Electrostatic Sprayer and ByoPlanet®-approved products should be allowed to operate.
6. Do not allow personnel to operate the sprayer without proper instruction or under the influence of alcohol or drugs.
7. Use an extension cord meeting or exceeding the specification detailed in the Extension Cord section.
8. Store sprayer in a cool, dry place. Do not expose to extreme temperatures. Do not store sprayer outdoors.
9. Purge liquid line before storing the unit.
10. Be aware, even when the sprayer is off, power is still supplied to the unit when plugged into an electrical outlet.

11. Never hang unit from cord.
12. A sprayer should never be left unattended when plugged in.
13. A resettable breaker is provided on the rear of the unit. It will trip if the unit experiences an electrical short.
14. Always turn off sprayer after each application and before unplugging.
15. Always unplug unit from outlet when not in use or when leaving it unattended.
16. Never unplug by pulling the cord or with wet hands. Always unplug by grasping the plug.
17. Do not pull or carry the sprayer by the power cord, nozzle or nozzle cord.
18. Do not crimp the cord or strain it around sharp edges, as doing so might damage the cord.
19. Do not use the ByoPlanet® MS-700™ Electrostatic Sprayer with a damaged power cord.
20. Always thoroughly inspect product before usage.

For questions or concerns about the ByoPlanet® MS-700™ Electrostatic Sprayer, contact Service Tech Team at **WWW.SERVICETECHTEAM.COM**.

Chemicals

The ByoPlanet® MS-700™ Electrostatic Sprayer can only be used with products that have been approved by ByoPlanet®. The ByoPlanet® MS-700™ Electrostatic Sprayer warranty is voided if the ByoPlanet® MS-700™ Electrostatic Sprayer is used with products that are not approved by ByoPlanet®. Be aware that many chemical liquids can be harmful if they are not used properly.

1. Always use appropriate personal protective equipment (PPE) when operating the ByoPlanet® MS-700™ Electrostatic Sprayer. Refer to product SDS for proper PPE.
2. Follow the liquid product label and SDS for proper storing, handling and disposing of any liquid products used in the ByoPlanet® MS-700™ Electrostatic Sprayer.
3. Know the length of time required by each liquid product application before allowing people and pets to return to the sprayed area.
4. Tampering with ByoPlanet®-approved products, product containers and the ByoPlanet® MS-700™ Electrostatic Sprayer in any form will void the customer warranty.
5. To dispose of ByoPlanet®-approved products refer to product labels.
6. If liquid products come into contact with your skin or eyes, please refer to product label and SDS.
7. Never aim the sprayer at yourself, another person or a pet.
8. Do not mix chemicals unless specifically directed on the product SDS and label.

IMPORTANT: Safety data sheets (SDS) are available for all liquid products that have been approved for use in the ByoPlanet® MS-700™ Electrostatic Sprayer. These SDSs will inform you of any hazards and precautions of which you should be aware. All employees that use the product must be aware of and have access to the SDS. They should also be trained for and aware of their safety while working with liquid products. It is the responsibility of the owner of the equipment to obtain an SDS from ByoPlanet® for each chemical used. Visit **WWW.SERVICETECHTEAM.COM** for more information.



SYSTEM COMPONENTS

The patented MS-700™ Electrostatic Sprayer was engineered with the end-user in mind. It is durable, highly mobile and incredibly effective for electrostatic delivery.

The peristaltic pump is the only field-serviceable component. If you are experiencing issues with your device, please contact Customer Support at WWW.SERVICETECHTEAM.COM.

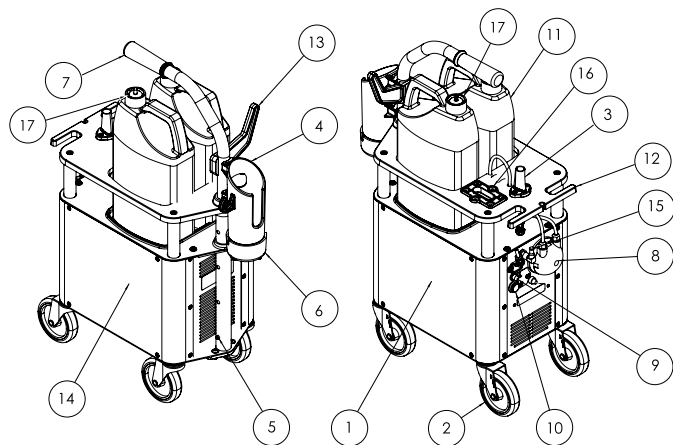
MS-700™ Electrostatic Sprayer Base Unit



- 1. Air Compressor**
Atomizes and propels the liquid. Includes built-in auto-re-setting thermal safeguard against compressor overheating.
- 2. Non-Marking Wheels**
Large wheels, for easy transport and maneuverability, will not leave scuff marks. Do not require inflation.
- 3. Sprayer Connect Line**
Connect line consists of three components: electrical line, liquid line and air line. The connect line connects the sprayer to the base unit.
- 4. Sprayer Holster**
Holds the sprayer.
- 5. Handle Adjust Buttons**
Adjusts handle height. (Squeeze to adjust.)
- 6. Removable Drip Cup**
Collects any dripping from the sprayer.
- 7. Adjustable Handle**
Handle position is raised, lowered and rotated by the two button snaps.
- 8. Peristaltic Pump**
Provides liquid up to sprayer.
- 9. Circuit Breaker**
User resettable circuit breaker and will only trip if a short occurs in the base unit. 
- 10. Main Power Switch**
Powers system to a ready state. 
- 11. 1-Gallon (3.8 Liters) Product containers**
Product Containers (not included with equipment).
- 12. Extension Cord Holder**
Located at the rear of the unit for extension cord storage.
- 13. Cord Management Hook**
Stores or hangs the extension cord.
- 14. Frame**
Base casing designed for long-term durability.

- 15. Sprayer Electrical Disconnect**
Electrical connection for sprayer.
- 16. Reservoir**
A reservoir to ensure a consistent liquid flow.
- 17. Dispensing Cap**
Allows solution to flow from the bottle to the liquid line.

MS-700™ Electrostatic Sprayer

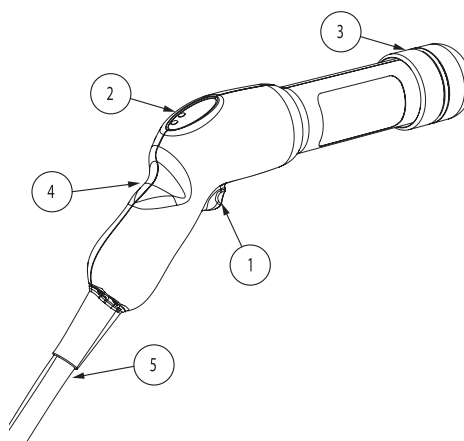

- 1. Sprayer Button**
1-click functionality / operates the sprayer/device.
- 2. Main Control Panel**
Indicates the power, sprayer and electrostatics are on.
- 3. Nozzle Cover**
Located on the front of the sprayer.
- 4. Spray Wand Handle**
Handle positioned for ambidextrous use.
- 5. Loom Assembly**
Connect line consists of three components: electrical line, liquid line and air line.

OPERATING INSTRUCTIONS

Preparing the Spray Area

1. Clean gross filth by using standard manual cleaning protocols.
2. Close the room to the general public for cleaning. Place signs or warning indicators on doors that indicate no one should enter the room.
3. Power off any sensitive electrical devices. Devices do not need to be unplugged.

Unit Operation/Setup

1. Choose the appropriate ByoPlanet®-approved product for cleaning, sanitizing or disinfecting.
2. Put on appropriate PPE. See section on PPE on page 5.
3. Mount desired ByoPlanet®-approved product on ByoPlanet® MS-700™ Electrostatic Sprayer base. Ensure that the bottles are positioned with the opening facing up and towards the dispensing tubes.
4. Unscrew the lid on the ByoPlanet®-approved product of your choice, remove seal (if present), and connect the ByoPlanet® MS-700™ Electrostatic Sprayer dispensing cap to the bottle. Be sure the cap is screwed all the way down; do not overtighten.
5. Unwrap electrical cord completely and plug ByoPlanet® MS-700™ Electrostatic Sprayer into a grounded, three-pronged outlet. See EXTENSION CORD section for extension cord specifications.

NOTE: For outside or wet environment application, use a GFCI (ground fault circuit interrupter) inline adapter or outlet to help avoid risk of electrical shock. The GFCI should be placed as close to the outlet as possible.

6. Locate the On/Off switch on the base unit. Push the ByoPlanet® MS-700™ sprayer to the "ON" position. A light will illuminate on the sprayer instrument panel.
7. Remove the sprayer from the unit.
8. The system is now ready for use.
9. Priming the ByoPlanet® MS-700™ Electrostatic Sprayer: Depress into an inconspicuous corner, container or drain. Spray the ByoPlanet® MS-700™ Electrostatic Sprayer for up to 20 seconds to generate a steady flow of solution.
10. When spraying, a second indicator light will illuminate on the sprayer instrument panel when the sprayer button is depressed.

NOTE: Sprayer will automatically stay on until sprayer button is depressed an additional time.

NOTE: Unit will not operate properly below 55°F (12.5°C). If unit has been stored where temperatures are below 55°F (12.5°C) move the unit to a warm environment and allow the unit to acclimate before operation.

Sprayer Operation

11. Position ByoPlanet® MS-700™ Electrostatic Sprayer in a rear corner of the area.
12. Direct the spray wand at the desired surface.
13. Begin to spray. Press the sprayer button once to initiate spraying. Press once to stop flow of the sprayer.

14. Follow a continuous path around the area, working from high to low areas, moving the sprayer in a sweeping motion until surfaces are thoroughly wet. Optimal spray distance away from surface is 2-4 feet (0.6-1.2 meters).
15. After spraying, keep the area closed to the public until applicable bystander re-entry times are reached (see the product SDS for information on bystander re-entry times). If no re-entry time is indicated, keep the area closed until product contact times are reached or surfaces are visibly dry.
16. Remove the closed sign from the door.

Changing ByoPlanet®-Approved Products

1. Stop spraying the ByoPlanet® MS-700™ Electrostatic Sprayer.
2. Disconnect the bottle connection from the ByoPlanet®-approved product that is to be changed and remove from the sprayer. Cap the removed product if it is being stored.
3. Purging the ByoPlanet® MS-700™ Electrostatic Sprayer: Depress into an inconspicuous corner, container or drain. Spray the ByoPlanet® MS-700™ Electrostatic Sprayer for up to 20 seconds to purge the system.
4. Choose the appropriate ByoPlanet®-approved product for cleaning, sanitizing or disinfecting.
5. Mount desired ByoPlanet®-approved product on ByoPlanet® MS-700™ Electrostatic Sprayer base. Ensure that the bottles are positioned with the opening facing up and towards the dispensing tubes.
6. Unscrew the lid on the ByoPlanet®-approved product of your choice, remove seal (if present), and connect the ByoPlanet® MS-700™ Electrostatic Sprayer dispensing cap to the bottle. Be sure the cap is screwed all the way down; do not overtighten.
7. Priming the ByoPlanet® MS-700™ Electrostatic Sprayer: Depress into an inconspicuous corner, container or drain. Spray the ByoPlanet® MS-700™ Electrostatic Sprayer for up to 20 seconds to generate a steady flow of solution.

After Use and Storage

1. Stop spraying the ByoPlanet® MS-700™ Electrostatic Sprayer.
2. Disconnect the bottle connection from the ByoPlanet®-approved product that is to be changed and remove from the sprayer. Cap the removed product if it is being stored.
3. Emptying drip cup holder (if necessary): Unscrew drip cup, making sure to hold it level to prevent spillage. Remove and empty the drip cup. Reinstall the empty drip cup by rotating it in the opposite direction until it is snug.
4. Purging the ByoPlanet® MS-700™ Electrostatic Sprayer: Depress into an inconspicuous corner, container or drain. Spray the ByoPlanet® MS-700™ Electrostatic Sprayer until no liquid comes out of the nozzle.
5. Turn off the unit. Indicator lights on the sprayer instrument panel should no longer be illuminated and power button should be in the OFF position.
6. Unplug the ByoPlanet® MS-700™ Electrostatic Sprayer from wall.
7. Wrap cord on cord holder on the MS-700™ base unit.
8. Store in a safe, dry place.

MAINTENANCE

In order for the ByoPlanet® MS-700™ Electrostatic Sprayer to remain functional, the equipment should be cleaned on a regular basis. In addition to general cleaning of the unit, one user-serviceable area — the peristaltic pump — may need to be serviced.

NOTE: As the sprayer becomes dirty from typical use, a 70% isopropyl alcohol cleaner that is manually applied is recommended on outside surfaces.

The sprayer body has no serviceable parts inside. DO NOT OPEN THE SPRAYER SHELL, AS DOING SO WILL VOID THE WARRANTY ON THE SPRAYER. If you need to have your sprayer serviced, contact Service Tech Team at www.servicetechteam.com.

Exterior Frame

To clean the exterior of the ByoPlanet® MS-700™ Electrostatic Sprayer

1. Purge all chemistry from the device.
2. When not in use, ensure the device is powered off and unplug the power cord from the wall outlet and device.
3. Wipe exterior surfaces of the device, including hose and nozzle, with a slightly damp cloth or towel to remove visible soil. Be sure that the cloth is well wrung out, and excess moisture has been removed.
4. For additional soil removal, wipe the exterior surfaces with a microfiber cloth that has been soaked in warm, soapy water. Be sure that the cloth is well wrung out, and excess moisture has been removed.
5. Let device dry thoroughly before operation is resumed.

Peristaltic Pump

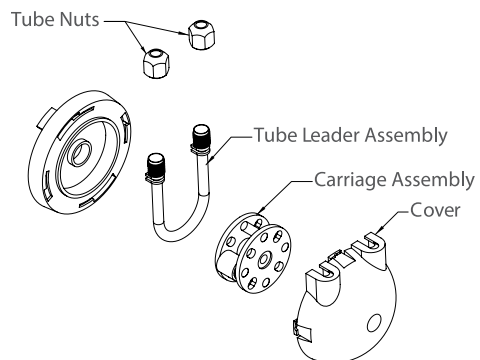

1. Disconnect the clear tubing inlet and outlet by twisting the Tube Nuts counterclockwise until both tubes have separated.
2. Rotate the Cover counterclockwise and pull the pump assembly free from the unit.
3. Install the new Pump Assembly in the reverse order that it was disassembled.

SPECIFICATIONS FOR 115V MODEL

Volts	~115V
Running AMPS	6.0
Minimum Operating Temperature	55°F (12.5°C) Allow to acclimate to room temperature if stored below 55°F (12.5°C)
Frequency	60 Hz
Standard Hose Length	7 ft. (2.13 m)
Dimensions	25 3/8 in. (64 cm) H x 10 1/16 in. (26 cm) W x 17 1/8 in. (43 cm) L
Air Line Pressure	35 psi (2.4 Bar)
Weight – Empty	43 lbs (20 kg)
Weight – Full	59 lbs (27 kg)
Shipping Weight	52 lbs (24 kg)
Flow Rate	110-130 mL/min

SPECIFICATIONS FOR 240V MODEL

Volts	~240V
Running AMPS	3.0
Minimum Operating Temperature	55°F (12.5°C) Allow to acclimate to room temperature if stored below 55°F (12.5°C)
Frequency	50 Hz
Standard Hose Length	7 ft. (2.13 m)
Dimensions	25 3/8 in. (64 cm) H x 10 1/16 in. (26 cm) W x 17 1/8 in. (43 cm) L
Air Line Pressure	35 psi (2.4 Bar)
Weight – Empty	43 lbs (20 kg)
Weight – Full	59 lbs (27 kg)
Shipping Weight	52 lbs (24 kg)
Flow Rate	110-130 mL/min

TROUBLESHOOTING

NOTE: DO NOT USE a chemical in the unit that is not a ByoPlanet®-approved product. If you encounter the issues listed below, use the suggested troubleshooting methods. If you encounter an issue that is not addressed in this manual, contact Service Tech Team at www.servicetechteam.com.

EXCESSIVE NOZZLE DRIPPING

Potential Issue	Corrective Action
Damage to nozzle assembly	Inspect for damage and faulty parts. If present, contact Service Tech Team.
Damage to peristaltic pump tubing	Replace pump tubing. Visit www.servicetechteam.com to request replacement parts.
Dirty exterior sprayer surfaces	Clean exterior surfaces with 70% isopropyl alcohol.

SYSTEM WILL NOT TURN ON OR HAS SHUT OFF SUDDENLY

Potential Issue	Corrective Action
No power	Verify the unit is plugged in and on a known working power outlet
System is not switched on	Depress power switch to illuminate, or toggle power switch to the ON position.
Compressor shuts off suddenly or won't run while depressing the sprayer trigger	This is a sign that the unit's circuit breaker has tripped or the compressor has overheated. The user should look for physical objects that could be loose or stuck in the ventilation openings and clear/dislodge. Flip the power switch back to the "ON" position. If the problem persists, the user should let the unit sit for 30 minutes to see if it's an overheating issue. If the unit still refuses to restart after 30 minutes, the user should contact Service Tech Team.
Compressor has overheated	Allow the unit to sit for a minimum of 30 minutes with the power off.
Unit stalls upon initial spray	If the air compressor does not come up to speed when pressing the trigger, this may be a sign that the unit has been stored below 55°F (12.5°C). If unit has been stored where temperatures are below 55°F (12.5°C) move the unit to a warm environment and allow the unit to acclimate before operation.

NO SPRAY, ERRATIC SPRAY OR WEAK SPRAY

POTENTIAL ISSUE	CORRECTIVE ACTION
Out of liquid solution	Inspect product container for solution level and replace if empty.
Blockage in the nozzle or liquid tip	Power down and unplug the unit. Visually inspect nozzle from outside for blockages. Note: Sprayer assembly, including the nozzle, is non-serviceable. If there are problems with obstructions in the sprayer or nozzle assembly, please contact Service Tech Team.
Spray appears weak	The user should power the unit off, unplug from the wall and seek out a different electrical outlet to try. If unavailable, they should look to see if other devices are running on the same electrical circuit. Power those off if necessary. This could be a result of an underrated extension cord. If an extension cord is being used, remove and test the unit while using only the connected power cord. See the extension cord section for more information.
Damage to liquid hose or peristaltic pump tubing	Inspect the liquid line for kinks and/or damage. Visit www.servicetechteam.com to request replacement parts.
No Liquid Flow	If unit has been stored without use for extended period of time, peristaltic pump may not operate properly upon startup. The user should run the unit for 5 minutes prior to use.

AIR PRESSURE SEEMS LOW OR WEAK

POTENTIAL ISSUE	CORRECTIVE ACTION
Damage to the air hose	Inspect hose for knicks, damage or areas where air is escaping.
Blockage in the nozzle	Power down and unplug unit. Visually inspect nozzle from outside for blockages. Note: Sprayer assembly, including the nozzle, is non-serviceable. If there are problems with obstructions in the sprayer or nozzle assembly, please contact Service Tech Team.
Compressor not starting properly.	If the air compressor does not come up to speed when pressing the trigger, this may be a sign that the unit has been stored below 55°F (12.5°C) If unit has been stored where temperatures are below 55°F (12.5°C) move the unit to a warm environment and allow the unit to acclimate before operation.

EQUIPMENT WARRANTY

THE BYOPLANET® MS-700™ ELECTROSTATIC SPRAYER COMES WITH A ONE-YEAR LIMITED WARRANTY. PLEASE REFER TO THE MANUFACTURER'S WARRANTY POLICY FOUND AT WWW.SERVICETECHTEAM.COM.

TO PURCHASE
A BYOPLANET®
ELECTROSTATIC
SPRAY SYSTEM

BYOPLANET.COM/SALES
1-877-220-0550

FOR CUSTOMER
COLLATERAL, INCLUDING
OPERATOR'S MANUAL
AND QUICK START GUIDES

SERVICETECHTEAM.COM
1-877-220-0550

FOR DEVICE
WARRANTY
INFORMATION

SERVICETECHTEAM.COM
1-877-220-0550

QUESTIONS?
SERVICETECHTEAM.COM
CONTACT US